

Product description

stainless steel Swivel castor with an overall height of 128 mm

Wheel diameter x width: 100 x 32 mm

Top plate with 4 mounting holes of 9 mm, mounting hole distance 80x60 mm and top plate outer dimensions: 105x85 mm

Wheel with plain bearing and grey rubber tyre with hardness 83 ° shore A on polypropylene.

Approved and tested load capacity

Dynamic 80 kg

Static 100 kg

Temperature range:

Continuous operation: -20 | +70°C

Short (10 min) exposure: -30 | +80°C

Advantages of this Floor floor turns Swivel castor:

- ✓ preservation
- ✓ and steam proof
- ✓ obstacle smooth pass

LIV SYSTEMS stainless steel Swivel castor + grey rubber tyre Ø100 x W32mm for 80kg Prod ID: 41495

ID 41495: Castor overall height 128 mm | 4 mounting holes with distance 80x60 mm | Wheel with plain bearing and grey rubber tyre with hardness 83 ° shore A | Floor floor turns, floor preservation, wet and steam proof, low obstacle smooth pass

Product information

- Article code 2-922 ISO
- SKU 41495
- EAN 3838461414954

Алматы (7273)495-231
Ангарск (3955)60-70-56
Архангельск (8182)63-90-72
Астрахань (8512)99-46-04
Барнаул (3852)73-04-60
Белгород (4722)40-23-64
Благовещенск (4162)22-76-07
Брянск (4832)59-03-52
Владивосток (423)249-28-31
Владикавказ (8672)28-90-48
Владимир (4922)49-43-18
Волгоград (844)278-03-48
Вологда (8172)26-41-59
Воронеж (473)204-51-73
Екатеринбург (343)384-55-89

Иваново (4932)77-34-06
Ижевск (3412)26-03-58
Иркутск (395)279-98-46
Казань (843)206-01-48
Калининград (4012)72-03-81
Калуга (4842)92-23-67
Кемерово (3842)65-04-62
Киров (8332)68-02-04
Коломна (4966)23-41-49
Кострома (4942)77-07-48
Краснодар (861)203-40-90
Красноярск (391)204-63-61
Курск (4712)77-13-04
Курган (3522)50-90-47
Липецк (4742)52-20-81

Магнитогорск (3519)55-03-13
Москва (495)268-04-70
Мурманск (8152)59-64-93
Набережные Челны (8552)20-53-41
Нижний Новгород (831)429-08-12
Новокузнецк (3843)20-46-81
Ноябрьск (3496)41-32-12
Новосибирск (383)227-86-73
Омск (3812)21-46-40
Орел (4862)44-53-42
Оренбург (3532)37-68-04
Пенза (8412)22-31-16
Петрозаводск (8142)55-98-37
Псков (8112)59-10-37
Пермь (342)205-81-47

Ростов-на-Дону (863)308-18-15
Рязань (4912)46-61-64
Самара (846)206-03-16
Санкт-Петербург (812)309-46-40
Саратов (845)249-38-78
Севастополь (8692)22-31-93
Саранск (8342)22-96-24
Симферополь (3652)67-13-56
Смоленск (4812)29-41-54
Сочи (862)225-72-31
Ставрополь (8652)20-65-13
Сургут (3462)77-98-35
Сыктывкар (8212)25-95-17
Тамбов (4752)50-40-97
Тверь (4822)63-31-35

Тольятти (8482)63-91-07
Томск (3822)98-41-53
Тула (4872)33-79-87
Тюмень (3452)66-21-18
Ульяновск (8422)24-23-59
Улан-Удэ (59-97-51
Уфа (347)229-48-12
Хабаровск (4212)92-98-04
Чебоксары (8352)28-53-07
Челябинск (351)202-03-61
Череповец (8202)49-02-64
Чита (3022)38-34-83
Якутск (4112)23-90-97
Ярославль (4852)69-52-93

Россия +7(495)268-04-70

Казахстан +7(7172)727-132

Киргизия +996(312)96-26-47

<https://liv.nt-rt.ru/> || vis@nt-rt.ru

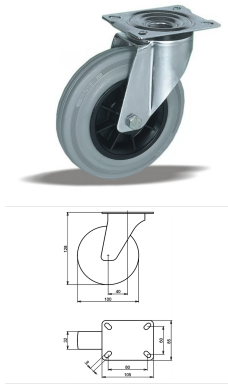

Product description

stainless steel Swivel castor with an overall height of 128 mm

Wheel diameter x width: 100 x 32 mm

Top plate with 4 mounting holes of 9 mm, mounting hole distance 80x60 mm and top plate outer dimensions: 105x85 mm

Wheel with roller bearing and grey rubber tyre with hardness 83 ° shore A on polypropylene.

Approved and tested load capacity

Dynamic 80 kg

Static 100 kg

Temperature range:

Continuous operation: -20 | +70°C

Short (10 min) exposure: -30 | +80°C

Advantages of this Floor floor turns Swivel castor:

- ✓ preservation
- ✓ and steam proof
- ✓ obstacle smooth pass

LIV SYSTEMS stainless steel Swivel castor + grey rubber tyre Ø100 x W32mm for 80kg Prod ID: 41494

ID 41494: Castor overall height 128 mm | 4 mounting holes with distance 80x60 mm | Wheel with roller bearing and grey rubber tyre with hardness 83 ° shore A | Floor floor turns, floor preservation, wet and steam proof, low obstacle smooth pass

Product information

- Article code 2-915 ISO
- SKU 41494
- EAN 3838461414947

Specifications

The result of our quality is maximum performance!

[Close](#)

[Close](#)

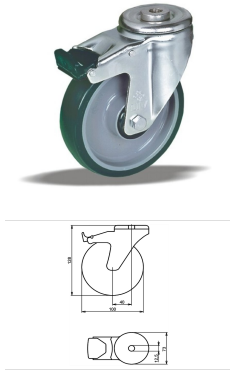

Product description

stainless steel Swivel castor with brake with an overall height of 128 mm
 Wheel diameter x width: 100 x 32 mm
 Top plate with 4 mounting holes of 12,5 mm, mounting hole distance #\$\$ mm and top plate outer dimensions: 73 mm
 Wheel with plain bearing and injection-moulded polyurethane tread with hardness 92 ° Shore A on polyamide
 the double brake system, brakes the turning of the wheel and the swivel rotation.

Approved and tested load capacity

Dynamic 150 kg
 Static 180 kg

Temperature range:

Continious operation: -25 | +55°C
 Short (10 min) exposure: -30 | +55°C

Advantages of this No trail highway drive Swivel castor with brake:

- ✓ deformation if rarely moved
- ✓ range of temperatures
- ✓ resistant

LIV SYSTEMS stainless steel Swivel castor with brake + injection-moulded polyurethane tread Ø100 x W32mm for 150kg Prod ID: 41405

ID 41405: Castor overall height 128 mm | 4 mounting holes with distance #\$\$ mm | Wheel with plain bearing and injection-moulded polyurethane tread with hardness 92 ° Shore A | The double brake system, brakes the turning of the wheel and the swivel rotatio

Product information

- Article code 2-055-20D
- SKU 41405
- EAN 3838461414053

Specifications

The result of our quality is maximum performance!

[Close](#)

[Close](#)

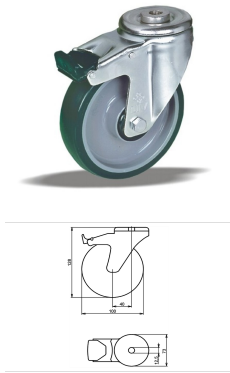

Product description

stainless steel Swivel castor with brake with an overall height of 128 mm

Wheel diameter x width: 100 x 32 mm

Top plate with 4 mounting holes of 12,5 mm, mounting hole distance #\$\$ mm and top plate outer dimensions: 73 mm

Wheel with roller bearing and injection-moulded polyurethane tread with hardness 92 ° Shore A on polyamide

the double brake system, brakes the turning of the wheel and the swivel rotation.

Approved and tested load capacity

Dynamic 150 kg

Static 180 kg

Temperature range:

Continuous operation: -25 | +55°C

Short (10 min) exposure: -30 | +55°C

Advantages of this No trail highway drive Swivel castor with brake:

- ✓ deformation if rarely moved
- ✓ range of temperatures
- ✓ resistant

LIV SYSTEMS stainless steel Swivel castor with brake + injection-moulded polyurethane tread Ø100 x W32mm for 150kg Prod ID: 41404

ID 41404: Castor overall height 128 mm | 4 mounting holes with distance #\$\$ mm | Wheel with roller bearing and injection-moulded polyurethane tread with hardness 92 ° Shore A | The double brake system, brakes the turning of the wheel and the swivel rotation

Product information

- Article code 2-055-20V
- SKU 41404
- EAN 3838461414046

Specifications

The result of our quality is maximum performance!

[Close](#)

[Close](#)

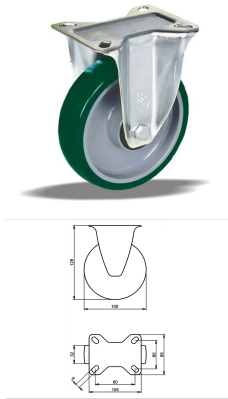

Product description

stainless steel Fixed castor with an overall height of 128 mm

Wheel diameter x width: 100 x 32 mm

Top plate with 4 mounting holes of 9 mm, mounting hole distance 80x60 mm and top plate outer dimensions: 105x85 mm

Wheel with ball bearing and injection-moulded polyurethane tread with hardness 92 ° Shore A on polyamide.

Approved and tested load capacity

Dynamic 150 kg

Static 180 kg

Temperature range:

Continuous operation: -25 | +55°C

Short (10 min) exposure: -30 | +55°C

Advantages of this No trail highway drive Fixed castor:

- ✓ deformation if rarely moved
- ✓ range of temperatures
- ✓ resistant

LIV SYSTEMS stainless steel Fixed castor + injection-moulded polyurethane tread Ø100 x W32mm for 150kg Prod

ID: 42154

ID 42154: Castor overall height 128 mm | 4 mounting holes with distance 80x60 mm | Wheel with ball bearing and injection-moulded polyurethane tread with hardness 92 ° Shore A | No trail highway drive, low deformation if rarely moved, wide range of tempera

Product information

- Article code 2-051-20K
- SKU 42154
- EAN 3838461421549

Specifications

The result of our quality is maximum performance!

[Close](#)

[Close](#)

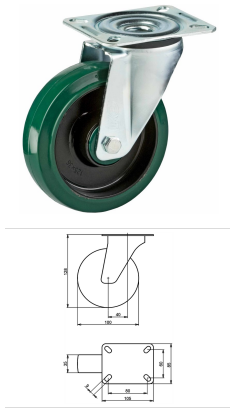

Product description

stainless steel Swivel castor with an overall height of 128 mm

Wheel diameter x width: 100 x 35 mm

Top plate with 4 mounting holes of 9 mm, mounting hole distance 80x60 mm and top plate outer dimensions: 105x85 mm

Wheel with ball bearing and elastic rubber tyre with hardness 70 ° Shore A on polyamide.

Approved and tested load capacity

Dynamic 150 kg

Static 180 kg

Temperature range:

Continuous operation: -25 | +80°C

Short (10 min) exposure: -30 | +110°C

Advantages of this Tile floor ride Swivel castor:

- ✓ absorbing
- ✓ ride over obstacles
- ✓ to keep clean

LIV SYSTEMS stainless steel Swivel castor + elastic rubber tyre Ø100 x W35mm for 150kg Prod ID: 42234

ID 42234: Castor overall height 128 mm | 4 mounting holes with distance 80x60 mm | Wheel with ball bearing and elastic rubber tyre with hardness 70 ° Shore A | Tile floor ride, shock absorbing, smooth ride over obstacles, easy to keep clean

Product information

- Article code 2-042-20K
- SKU 42234
- EAN 3838461422348

Specifications

The result of our quality is maximum performance!

[Close](#)

[Close](#)



Product description

stainless steel Swivel castor with brake with an overall height of 128 mm

Wheel diameter x width: 100 x 35 mm

Top plate with 4 mounting holes of 9 mm, mounting hole distance 80x60 mm and top plate outer dimensions: 105x85 mm

Wheel with ball bearing and elastic rubber tyre with hardness 70 ° Shore A on polyamide
the double brake system, brakes the turning of the wheel and the swivel rotation.

Approved and tested load capacity

Dynamic 150 kg

Static 180 kg

Temperature range:

Continuous operation: -25 | +80°C

Short (10 min) exposure: -30 | +110°C

Advantages of this Tile floor ride Swivel castor with brake:

- ✓ absorbing
- ✓ ride over obstacles
- ✓ to keep clean

LIV SYSTEMS stainless steel Swivel castor with brake + elastic rubber tyre Ø100 x W35mm for 150kg Prod ID: 42245

ID 42245: Castor overall height 128 mm | 4 mounting holes with distance 80x60 mm | Wheel with ball bearing and elastic rubber tyre with hardness 70 ° Shore A | The double brake system, brakes the turning of the wheel and the swivel rotation. | Tile floor

Product information

- Article code 2-043-20K
- SKU 42245
- EAN 3838461422454

Specifications

The result of our quality is maximum performance!

[Close](#)

[Close](#)



Product description

stainless steel Wheel with ball bearing and injection-moulded polyurethane tread with hardness 92 ° Shore A on polyamide

Wheel diameter x width: 100 x 32 mm

Axle hole: 12 mm

Hub length: 44 mm

Approved and tested load capacity

Dynamic 150 kg

Static 180 kg

Temperature range:

Continuous operation: -25 | +55°C

Short (10 min) exposure: -30 | +55°C

Advantages of this No trail highway drive wheel:

- ✓ deform if stationed
- ✓ range of temperatures
- ✓ resistant

LIV SYSTEMS stainless steel wheel + injection-moulded polyurethane tread Ø100 x W32mm for 150kg Prod ID: 42135

ID 42135: stainless steel Wheel with ball bearing and injection-moulded polyurethane tread with hardness 92 ° Shore A on polyamide | Axle hole: 12 mm | Hub length: 44 mm | No trail highway drive, low deform if stationed, wide range of temperatures, oil res

Product information

- Article code 2-050-20K
- SKU 42135
- EAN 3838461421358

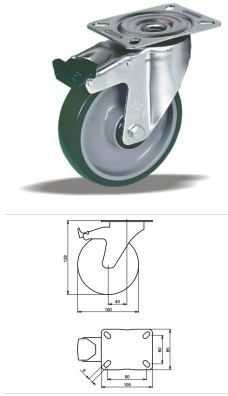

Product description

stainless steel Swivel castor with brake with an overall height of 128 mm

Wheel diameter x width: 100 x 32 mm

Top plate with 4 mounting holes of 9 mm, mounting hole distance 80x60 mm and top plate outer dimensions: 105x85 mm

Wheel with ball bearing and injection-moulded polyurethane tread with hardness 92 ° Shore A on polyamide

the double brake system, brakes the turning of the wheel and the swivel rotation.

Approved and tested load capacity

Dynamic 150 kg

Static 180 kg

Temperature range:

Continuous operation: -25 | +55°C

Short (10 min) exposure: -30 | +55°C

Advantages of this No trail highway drive Swivel castor with brake:

- ✓ deformation if rarely moved
- ✓ range of temperatures
- ✓ resistant

LIV SYSTEMS stainless steel Swivel castor with brake + injection-moulded polyurethane tread Ø100 x W32mm for 150kg Prod ID: 42183

ID 42183: Castor overall height 128 mm | 4 mounting holes with distance 80x60 mm | Wheel with ball bearing and injection-moulded polyurethane tread with hardness 92 ° Shore A | The double brake system, brakes the turning of the wheel and the swivel rotation

Product information

- Article code 2-053-20K
- SKU 42183
- EAN 3838461421839

Specifications

The result of our quality is maximum performance!

[Close](#)

[Close](#)



Product description

stainless steel Wheel with ball bearing and elastic rubber tyre with hardness 70 ° Shore A on polyamide

Wheel diameter x width: 100 x 35 mm

Axle hole: 12 mm

Hub length: 44 mm

Approved and tested load capacity

Dynamic 150 kg

Static 180 kg

Temperature range:

Continuous operation: -25 | +80°C

Short (10 min) exposure: -30 | +110°C

Advantages of this Tile floor ride wheel:

- ✓ absorbing
- ✓ ride over obstacles
- ✓ to keep clean

LIV SYSTEMS stainless steel wheel + elastic rubber tyre Ø100 x W35mm for 150kg Prod ID: 42144

ID 42144: stainless steel Wheel with ball bearing and elastic rubber tyre with hardness 70 ° Shore A on polyamide |

Axle hole: 12 mm | Hub length: 44 mm | Tile floor ride, shock absorbing, smooth ride over obstacles, easy to keep clean

Product information

- Article code 2-040-20K
- SKU 42144
- EAN 3838461421440

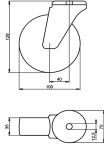

Product description

stainless steel Swivel castor with an overall height of 128 mm

Wheel diameter x width: 100 x 35 mm

Top plate with 4 mounting holes of 12,5 mm, mounting hole distance #\$\$ mm and top plate outer dimensions: 70 mm

Wheel with ball bearing and elastic rubber tyre with hardness 70 ° Shore A on polyamide.

Approved and tested load capacity

Dynamic 150 kg

Static 180 kg

Temperature range:

Continuous operation: -25 | +80°C

Short (10 min) exposure: -30 | +110°C

Advantages of this Tile floor ride Swivel castor:

- ✓ absorbing
- ✓ ride over obstacles
- ✓ to keep clean

LIV SYSTEMS stainless steel Swivel castor + elastic rubber tyre Ø100 x W35mm for 150kg Prod ID: 42263

ID 42263: Castor overall height 128 mm | 4 mounting holes with distance #\$\$ mm | Wheel with ball bearing and elastic rubber tyre with hardness 70 ° Shore A | Tile floor ride, shock absorbing, smooth ride over obstacles, easy to keep clean

Product information

- Article code 2-044-20K
- SKU 42263
- EAN 3838461422638

Specifications

The result of our quality is maximum performance!

[Close](#)

[Close](#)



Product description

stainless steel Swivel castor with brake with an overall height of 128 mm

Wheel diameter x width: 100 x 35 mm

Top plate with 4 mounting holes of 12,5 mm, mounting hole distance #\$\$ mm and top plate outer dimensions: 70 mm

Wheel with plain bearing and elastic rubber tyre with hardness 70 ° Shore A on polyamide

the double brake system, brakes the turning of the wheel and the swivel rotation.

Approved and tested load capacity

Dynamic 150 kg

Static 180 kg

Temperature range:

Continuous operation: -25 | +80°C

Short (10 min) exposure: -30 | +110°C

Advantages of this Tile floor ride Swivel castor with brake:

- ✓ absorbing
- ✓ ride over obstacles
- ✓ to keep clean

LIV SYSTEMS stainless steel Swivel castor with brake + elastic rubber tyre Ø100 x W35mm for 150kg Prod ID: 41624

ID 41624: Castor overall height 128 mm | 4 mounting holes with distance #\$\$ mm | Wheel with plain bearing and elastic rubber tyre with hardness 70 ° Shore A | The double brake system, brakes the turning of the wheel and the swivel rotation. | Tile floor r

Product information

- Article code 2-045-20D
- SKU 41624
- EAN 3838461416248

Specifications

The result of our quality is maximum performance!

[Close](#)

[Close](#)



Product description

stainless steel Swivel castor with brake with an overall height of 128 mm

Wheel diameter x width: 100 x 35 mm

Top plate with 4 mounting holes of 12,5 mm, mounting hole distance #\$\$ mm and top plate outer dimensions: 70 mm

Wheel with ball bearing and elastic rubber tyre with hardness 70 ° Shore A on polyamide

the double brake system, brakes the turning of the wheel and the swivel rotation.

Approved and tested load capacity

Dynamic 150 kg

Static 180 kg

Temperature range:

Continuous operation: -25 | +80°C

Short (10 min) exposure: -30 | +110°C

Advantages of this Tile floor ride Swivel castor with brake:

- ✓ absorbing
- ✓ ride over obstacles
- ✓ to keep clean

LIV SYSTEMS stainless steel Swivel castor with brake + elastic rubber tyre Ø100 x W35mm for 150kg Prod ID:

42274

ID 42274: Castor overall height 128 mm | 4 mounting holes with distance #\$\$ mm | Wheel with ball bearing and elastic rubber tyre with hardness 70 ° Shore A | The double brake system, brakes the turning of the wheel and the swivel rotation. | Tile floor ri

Product information

- Article code 2-045-20K
- SKU 42274
- EAN 3838461422744

Specifications

The result of our quality is maximum performance!

[Close](#)

[Close](#)

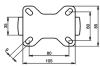

Product description

stainless steel Fixed castor with an overall height of 128 mm

Wheel diameter x width: 100 x 35 mm

Top plate with 4 mounting holes of 9 mm, mounting hole distance 80x60 mm and top plate outer dimensions: 105x85 mm

Wheel with ball bearing and elastic rubber tyre with hardness 70 ° Shore A on polyamide.

Approved and tested load capacity

Dynamic 150 kg

Static 180 kg

Temperature range:

Continuous operation: -25 | +80°C

Short (10 min) exposure: -30 | +110°C

Advantages of this Tile floor ride Fixed castor:

- ✓ absorbing
- ✓ ride over obstacles
- ✓ to keep clean

LIV SYSTEMS stainless steel Fixed castor + elastic rubber tyre Ø100 x W35mm for 150kg Prod ID: 42223

ID 42223: Castor overall height 128 mm | 4 mounting holes with distance 80x60 mm | Wheel with ball bearing and elastic rubber tyre with hardness 70 ° Shore A | Tile floor ride, shock absorbing, smooth ride over obstacles, easy to keep clean

Product information

- Article code 2-041-20K
- SKU 42223
- EAN 3838461422232

Specifications

The result of our quality is maximum performance!

[Close](#)

[Close](#)

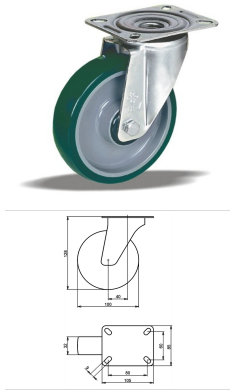

Product description

stainless steel Swivel castor with an overall height of 128 mm

Wheel diameter x width: 100 x 32 mm

Top plate with 4 mounting holes of 9 mm, mounting hole distance 80x60 mm and top plate outer dimensions: 105x85 mm

Wheel with plain bearing and injection-moulded polyurethane tread with hardness 92 ° Shore A on polyamide.

Approved and tested load capacity

Dynamic 150 kg

Static 180 kg

Temperature range:

Continuous operation: -25 | +55°C

Short (10 min) exposure: -30 | +55°C

Advantages of this No trail highway drive Swivel castor:

- ✓ deformation if rarely moved
- ✓ range of temperatures
- ✓ resistant

LIV SYSTEMS stainless steel Swivel castor + injection-moulded polyurethane tread Ø100 x W32mm for 150kg Prod ID: 41365

ID 41365: Castor overall height 128 mm | 4 mounting holes with distance 80x60 mm | Wheel with plain bearing and injection-moulded polyurethane tread with hardness 92 ° Shore A | No trail highway drive, low deformation if rarely moved, wide range of temper

Product information

- Article code 2-052-20D
- SKU 41365
- EAN 3838461413650

Specifications

The result of our quality is maximum performance!

[Close](#)

[Close](#)

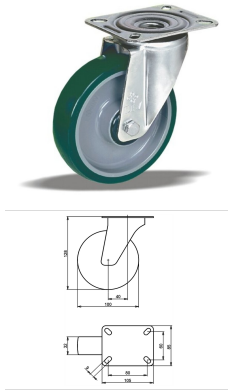

Product description

stainless steel Swivel castor with an overall height of 128 mm

Wheel diameter x width: 100 x 32 mm

Top plate with 4 mounting holes of 9 mm, mounting hole distance 80x60 mm and top plate outer dimensions: 105x85 mm

Wheel with ball bearing and injection-moulded polyurethane tread with hardness 92 ° Shore A on polyamide.

Approved and tested load capacity

Dynamic 150 kg

Static 180 kg

Temperature range:

Continuous operation: -25 | +55°C

Short (10 min) exposure: -30 | +55°C

Advantages of this No trail highway drive Swivel castor:

- ✓ deformation if rarely moved
- ✓ range of temperatures
- ✓ resistant

LIV SYSTEMS stainless steel Swivel castor + injection-moulded polyurethane tread Ø100 x W32mm for 150kg Prod ID: 42165

ID 42165: Castor overall height 128 mm | 4 mounting holes with distance 80x60 mm | Wheel with ball bearing and injection-moulded polyurethane tread with hardness 92 ° Shore A | No trail highway drive, low deformation if rarely moved, wide range of tempera

Product information

- Article code 2-052-20K
- SKU 42165
- EAN 3838461421655

Specifications

The result of our quality is maximum performance!

[Close](#)

[Close](#)

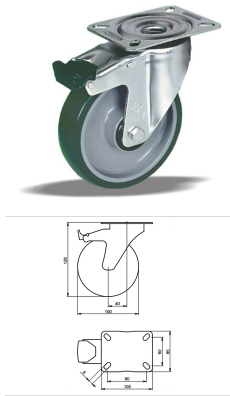

Product description

stainless steel Swivel castor with brake with an overall height of 128 mm

Wheel diameter x width: 100 x 32 mm

Top plate with 4 mounting holes of 9 mm, mounting hole distance 80x60 mm and top plate outer dimensions: 105x85 mm

Wheel with plain bearing and injection-moulded polyurethane tread with hardness 92 ° Shore A on polyamide

the double brake system, brakes the turning of the wheel and the swivel rotation.

Approved and tested load capacity

Dynamic 150 kg

Static 180 kg

Temperature range:

Continuous operation: -25 | +55°C

Short (10 min) exposure: -30 | +55°C

Advantages of this No trail highway drive Swivel castor with brake:

- ✓ deformation if rarely moved
- ✓ range of temperatures
- ✓ resistant

LIV SYSTEMS stainless steel Swivel castor with brake + injection-moulded polyurethane tread Ø100 x W32mm for 150kg Prod ID: 41383

ID 41383: Castor overall height 128 mm | 4 mounting holes with distance 80x60 mm | Wheel with plain bearing and injection-moulded polyurethane tread with hardness 92 ° Shore A | The double brake system, brakes the turning of the wheel and the swivel rotation

Product information

- Article code 2-053-20D
- SKU 41383
- EAN 3838461413834

Specifications

The result of our quality is maximum performance!

[Close](#)

[Close](#)

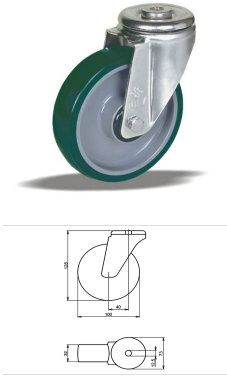

Product description

stainless steel Swivel castor with brake with an overall height of 128 mm
 Wheel diameter x width: 100 x 32 mm
 Top plate with 4 mounting holes of 12,5 mm, mounting hole distance 105x80 mm and top plate outer dimensions: 73 mm
 Wheel with ball bearing and injection-moulded polyurethane tread with hardness 92 ° Shore A on polyamide
 the double brake system, brakes the turning of the wheel and the swivel rotation.

Approved and tested load capacity

Dynamic 150 kg
 Static 180 kg

Temperature range:

Continious operation: -25 | +55°C
 Short (10 min) exposure: -30 | +55°C

Advantages of this No trail highway drive Swivel castor with brake:

- ✓ deformation if rarely moved
- ✓ range of temperatures
- ✓ resistant

LIV SYSTEMS stainless steel Swivel castor with brake + injection-moulded polyurethane tread Ø100 x W32mm for 150kg Prod ID: 42194

ID 42194: Castor overall height 128 mm | 4 mounting holes with distance 105x80 mm | Wheel with ball bearing and injection-moulded polyurethane tread with hardness 92 ° Shore A | The double brake system, brakes the turning of the wheel and the swivel rotat

Product information

- Article code 2-054-20K
- SKU 42194
- EAN 3838461421945

Specifications

The result of our quality is maximum performance!

[Close](#)

[Close](#)

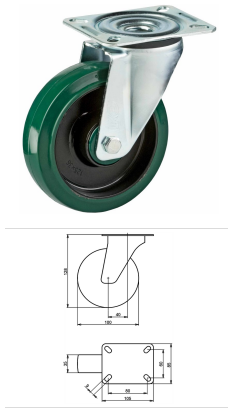

Product description

stainless steel Swivel castor with an overall height of 128 mm

Wheel diameter x width: 100 x 35 mm

Top plate with 4 mounting holes of 9 mm, mounting hole distance 80x60 mm and top plate outer dimensions: 105x85 mm

Wheel with plain bearing and elastic rubber tyre with hardness 70 ° Shore A on polyamide.

Approved and tested load capacity

Dynamic 150 kg

Static 180 kg

Temperature range:

Continuous operation: -25 | +80°C

Short (10 min) exposure: -30 | +110°C

Advantages of this Tile floor ride Swivel castor:

- ✓ absorbing
- ✓ ride over obstacles
- ✓ to keep clean

LIV SYSTEMS stainless steel Swivel castor + elastic rubber tyre Ø100 x W35mm for 150kg Prod ID: 41584

ID 41584: Castor overall height 128 mm | 4 mounting holes with distance 80x60 mm | Wheel with plain bearing and elastic rubber tyre with hardness 70 ° Shore A | Tile floor ride, shock absorbing, smooth ride over obstacles, easy to keep clean

Product information

- Article code 2-042-20D
- SKU 41584
- EAN 3838461415845

Specifications

The result of our quality is maximum performance!

[Close](#)

[Close](#)



Product description

stainless steel Swivel castor with brake with an overall height of 128 mm

Wheel diameter x width: 100 x 35 mm

Top plate with 4 mounting holes of 9 mm, mounting hole distance 80x60 mm and top plate outer dimensions: 105x85 mm

Wheel with plain bearing and elastic rubber tyre with hardness 70 ° Shore A on polyamide

the double brake system, brakes the turning of the wheel and the swivel rotation.

Approved and tested load capacity

Dynamic 150 kg

Static 180 kg

Temperature range:

Continuous operation: -25 | +80°C

Short (10 min) exposure: -30 | +110°C

Advantages of this Tile floor ride Swivel castor with brake:

- ✓ absorbing
- ✓ ride over obstacles
- ✓ to keep clean

LIV SYSTEMS stainless steel Swivel castor with brake + elastic rubber tyre Ø100 x W35mm for 150kg Prod ID: 41595

ID 41595: Castor overall height 128 mm | 4 mounting holes with distance 80x60 mm | Wheel with plain bearing and elastic rubber tyre with hardness 70 ° Shore A | The double brake system, brakes the turning of the wheel and the swivel rotation. | Tile floor

Product information

- Article code 2-043-20D
- SKU 41595
- EAN 3838461415951

Specifications

The result of our quality is maximum performance!

[Close](#)

[Close](#)

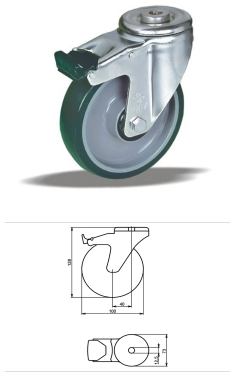

Product description

stainless steel Swivel castor with brake with an overall height of 128 mm
 Wheel diameter x width: 100 x 32 mm
 Top plate with 4 mounting holes of 12,5 mm, mounting hole distance #\$\$ mm and top plate outer dimensions: 73 mm
 Wheel with ball bearing and injection-moulded polyurethane tread with hardness 92 ° Shore A on polyamide
 the double brake system, brakes the turning of the wheel and the swivel rotation.

Approved and tested load capacity

Dynamic 150 kg
 Static 180 kg

Temperature range:

Continious operation: -25 | +55°C
 Short (10 min) exposure: -30 | +55°C

Advantages of this No trail highway drive Swivel castor with brake:

- ✓ deformation if rarely moved
- ✓ range of temperatures
- ✓ resistant

LIV SYSTEMS stainless steel Swivel castor with brake + injection-moulded polyurethane tread Ø100 x W32mm for 150kg Prod ID: 42205

ID 42205: Castor overall height 128 mm | 4 mounting holes with distance #\$\$ mm | Wheel with ball bearing and injection-moulded polyurethane tread with hardness 92 ° Shore A | The double brake system, brakes the turning of the wheel and the swivel rotation

Product information

- Article code 2-055-20K
- SKU 42205
- EAN 3838461422058

Specifications

The result of our quality is maximum performance!

[Close](#)

[Close](#)

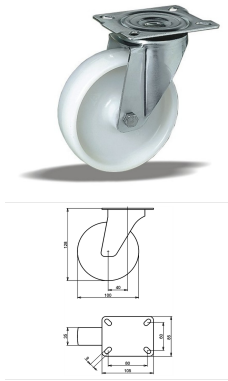

Product description

stainless steel Swivel castor with an overall height of 128 mm

Wheel diameter x width: 100 x 35 mm

Top plate with 4 mounting holes of 9 mm, mounting hole distance 80x60 mm and top plate outer dimensions: 105x85 mm

Wheel with roller bearing and solid polyamide wheel with hardness 70±5 Shore D.

Approved and tested load capacity

Dynamic 200 kg

Static 250 kg

Temperature range:

Continuous operation: -25 | +80°C

Short (10 min) exposure: -30 | +110°C

Advantages of this Steamy floor in Swivel castor:

- ✓ washing allowed
- ✓ shining
- ✓ hot and wet conditions

LIV SYSTEMS stainless steel Swivel castor + solid polyamide wheel Ø100 x W35mm for 200kg Prod ID: 41275

ID 41275: Castor overall height 128 mm | 4 mounting holes with distance 80x60 mm | Wheel with roller bearing and solid polyamide wheel with hardness 70±5 Shore D | Steamy floor in, frequent washing allowed, always shining, for hot and wet conditions

Product information

- Article code 2-661 A
- SKU 41275
- EAN 3838461412752

Specifications

The result of our quality is maximum performance!

[Close](#)

[Close](#)



Product description

stainless steel Wheel with roller bearing and elastic rubber tyre with hardness 70 ° Shore A on polyamide

Wheel diameter x width: 100 x 35 mm

Axle hole: 12 mm

Hub length: 44 mm

Approved and tested load capacity

Dynamic 150 kg

Static 180 kg

Temperature range:

Continuous operation: -25 | +80°C

Short (10 min) exposure: -30 | +110°C

Advantages of this Tile floor ride wheel:

- ✓ absorbing
- ✓ ride over obstacles
- ✓ to keep clean

LIV SYSTEMS stainless steel wheel + elastic rubber tyre Ø100 x W35mm for 150kg Prod ID: 42314

ID 42314: stainless steel Wheel with roller bearing and elastic rubber tyre with hardness 70 ° Shore A on polyamide |

Axle hole: 12 mm | Hub length: 44 mm | Tile floor ride, shock absorbing, smooth ride over obstacles, easy to keep clean

Product information

- Article code 2-040-20V
- SKU 42314
- EAN 3838461423147

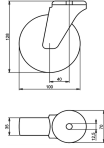

Product description

stainless steel Swivel castor with an overall height of 128 mm

Wheel diameter x width: 100 x 35 mm

Top plate with 4 mounting holes of 12,5 mm, mounting hole distance #\$\$ mm and top plate outer dimensions: 70 mm

Wheel with plain bearing and elastic rubber tyre with hardness 70 ° Shore A on polyamide.

Approved and tested load capacity

Dynamic 150 kg

Static 180 kg

Temperature range:

Continuous operation: -25 | +80°C

Short (10 min) exposure: -30 | +110°C

Advantages of this Tile floor ride Swivel castor:

- ✓ absorbing
- ✓ ride over obstacles
- ✓ to keep clean

LIV SYSTEMS stainless steel Swivel castor + elastic rubber tyre Ø100 x W35mm for 150kg Prod ID: 41613

ID 41613: Castor overall height 128 mm | 4 mounting holes with distance #\$\$ mm | Wheel with plain bearing and elastic rubber tyre with hardness 70 ° Shore A | Tile floor ride, shock absorbing, smooth ride over obstacles, easy to keep clean

Product information

- Article code 2-044-20D
- SKU 41613
- EAN 3838461416132

Specifications

The result of our quality is maximum performance!

[Close](#)

[Close](#)

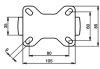

Product description

stainless steel Fixed castor with an overall height of 128 mm

Wheel diameter x width: 100 x 35 mm

Top plate with 4 mounting holes of 9 mm, mounting hole distance 80x60 mm and top plate outer dimensions: 105x85 mm

Wheel with plain bearing and elastic rubber tyre with hardness 70 ° Shore A on polyamide.

Approved and tested load capacity

Dynamic 150 kg

Static 180 kg

Temperature range:

Continuous operation: -25 | +80°C

Short (10 min) exposure: -30 | +110°C

Advantages of this Tile floor ride Fixed castor:

- ✓ absorbing
- ✓ ride over obstacles
- ✓ to keep clean

LIV SYSTEMS stainless steel Fixed castor + elastic rubber tyre Ø100 x W35mm for 150kg Prod ID: 41573

ID 41573: Castor overall height 128 mm | 4 mounting holes with distance 80x60 mm | Wheel with plain bearing and elastic rubber tyre with hardness 70 ° Shore A | Tile floor ride, shock absorbing, smooth ride over obstacles, easy to keep clean

Product information

- Article code 2-041-20D
- SKU 41573
- EAN 3838461415739

Specifications

The result of our quality is maximum performance!

[Close](#)

[Close](#)

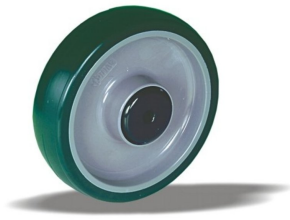

Product description

stainless steel Wheel with plain bearing and injection-moulded polyurethane tread with hardness 92 ° Shore A on polyamide

Wheel diameter x width: 100 x 32 mm

Axle hole: 8,5 mm

Hub length: 44 mm

Approved and tested load capacity

Dynamic 150 kg

Static 180 kg

Temperature range:

Continuous operation: -25 | +55°C

Short (10 min) exposure: -30 | +55°C

Advantages of this No trail highway drive wheel:

- ✓ deform if stationed
- ✓ range of temperatures
- ✓ resistant

LIV SYSTEMS stainless steel wheel + injection-moulded polyurethane tread Ø100 x W32mm for 150kg Prod ID: 43085

ID 43085: stainless steel Wheel with plain bearing and injection-moulded polyurethane tread with hardness 92 ° Shore A on polyamide | Axle hole: 8,5 mm | Hub length: 44 mm | No trail highway drive, low deform if stationed, wide range of temperatures, oil r

Product information

- Article code 2-050-20D
- SKU 43085
- EAN 3838461430855

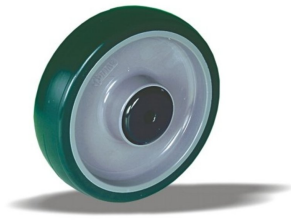

Product description

stainless steel Wheel with roller bearing and injection-moulded polyurethane tread with hardness 92 ° Shore A on polyamide

Wheel diameter x width: 100 x 32 mm

Axle hole: 8,5 mm

Hub length: 44 mm

Approved and tested load capacity

Dynamic 150 kg

Static 180 kg

Temperature range:

Continuous operation: -25 | +55°C

Short (10 min) exposure: -30 | +55°C

Advantages of this No trail highway drive wheel:

- ✓ deform if stationed
- ✓ range of temperatures
- ✓ resistant

LIV SYSTEMS stainless steel wheel + injection-moulded polyurethane tread Ø100 x W32mm for 150kg Prod ID: 42945

ID 42945:stainless steel Wheel with roller bearing and injection-moulded polyurethane tread with hardness 92 ° Shore A on polyamide | Axle hole: 8,5 mm | Hub length: 44 mm | No trail highway drive, low deform if stationed, wide range of temperatures, oil

Product information

- Article code 2-050-20V
- SKU 42945
- EAN 3838461429453

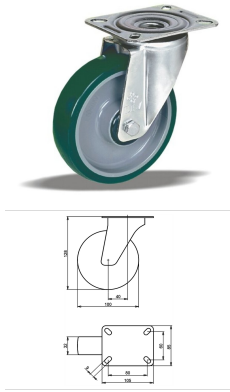

Product description

stainless steel Swivel castor with an overall height of 128 mm

Wheel diameter x width: 100 x 32 mm

Top plate with 4 mounting holes of 9 mm, mounting hole distance 80x60 mm and top plate outer dimensions: 105x85 mm

Wheel with roller bearing and injection-moulded polyurethane tread with hardness 92 ° Shore A on polyamide.

Approved and tested load capacity

Dynamic 150 kg

Static 180 kg

Temperature range:

Continuous operation: -25 | +55°C

Short (10 min) exposure: -30 | +55°C

Advantages of this No trail highway drive Swivel castor:

- ✓ deformation if rarely moved
- ✓ range of temperatures
- ✓ resistant

LIV SYSTEMS stainless steel Swivel castor + injection-moulded polyurethane tread Ø100 x W32mm for 150kg Prod ID: 41364

ID 41364: Castor overall height 128 mm | 4 mounting holes with distance 80x60 mm | Wheel with roller bearing and injection-moulded polyurethane tread with hardness 92 ° Shore A | No trail highway drive, low deformation if rarely moved, wide range of tempe

Product information

- Article code 2-052-20V
- SKU 41364
- EAN 3838461413643

Specifications

The result of our quality is maximum performance!

[Close](#)

[Close](#)

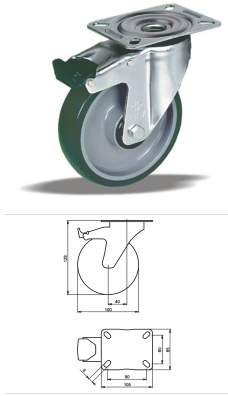

Product description

stainless steel Swivel castor with brake with an overall height of 128 mm

Wheel diameter x width: 100 x 32 mm

Top plate with 4 mounting holes of 9 mm, mounting hole distance 80x60 mm and top plate outer dimensions: 105x85 mm

Wheel with roller bearing and injection-moulded polyurethane tread with hardness 92 ° Shore A on polyamide

the double brake system, brakes the turning of the wheel and the swivel rotation.

Approved and tested load capacity

Dynamic 150 kg

Static 180 kg

Temperature range:

Continuous operation: -25 | +55°C

Short (10 min) exposure: -30 | +55°C

Advantages of this No trail highway drive Swivel castor with brake:

- ✓ deformation if rarely moved
- ✓ range of temperatures
- ✓ resistant

LIV SYSTEMS stainless steel Swivel castor with brake + injection-moulded polyurethane tread Ø100 x W32mm for 150kg Prod ID: 41375

ID 41375: Castor overall height 128 mm | 4 mounting holes with distance 80x60 mm | Wheel with roller bearing and injection-moulded polyurethane tread with hardness 92 ° Shore A | The double brake system, brakes the turning of the wheel and the swivel rota

Product information

- Article code 2-053-20V
- SKU 41375
- EAN 3838461413759

Specifications

The result of our quality is maximum performance!

[Close](#)

[Close](#)

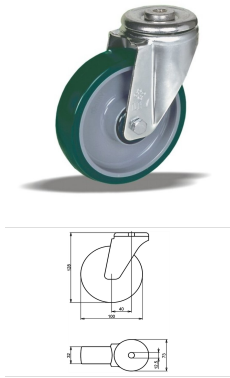

Product description

stainless steel Swivel castor with an overall height of 128 mm

Wheel diameter x width: 100 x 32 mm

Top plate with 4 mounting holes of 12,5 mm, mounting hole distance #\$\$ mm and top plate outer dimensions: 73 mm

Wheel with plain bearing and injection-moulded polyurethane tread with hardness 92 ° Shore A on polyamide.

Approved and tested load capacity

Dynamic 150 kg

Static 180 kg

Temperature range:

Continous operation: -25 | +55°C

Short (10 min) exposure: -30 | +55°C

Advantages of this No trail highway drive Swivel castor:

- ✓ deformation if rarely moved
- ✓ range of temperatures
- ✓ resistant

LIV SYSTEMS stainless steel Swivel castor + injection-moulded polyurethane tread Ø100 x W32mm for 150kg Prod ID: 41394

ID 41394: Castor overall height 128 mm | 4 mounting holes with distance #\$\$ mm | Wheel with plain bearing and injection-moulded polyurethane tread with hardness 92 ° Shore A | No trail highway drive, low deformation if rarely moved, wide range of temperat

Product information

- Article code 2-054-20D
- SKU 41394
- EAN 3838461413940

Specifications

The result of our quality is maximum performance!

[Close](#)

[Close](#)

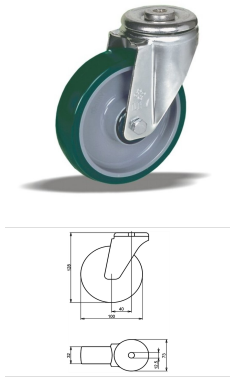

Product description

stainless steel Swivel castor with an overall height of 128 mm

Wheel diameter x width: 100 x 32 mm

Top plate with 4 mounting holes of 12,5 mm, mounting hole distance #\$\$ mm and top plate outer dimensions: 73 mm

Wheel with roller bearing and injection-moulded polyurethane tread with hardness 92 ° Shore A on polyamide.

Approved and tested load capacity

Dynamic 150 kg

Static 180 kg

Temperature range:

Continous operation: -25 | +55°C

Short (10 min) exposure: -30 | +55°C

Advantages of this No trail highway drive Swivel castor:

- ✓ deformation if rarely moved
- ✓ range of temperatures
- ✓ resistant

LIV SYSTEMS stainless steel Swivel castor + injection-moulded polyurethane tread Ø100 x W32mm for 150kg Prod ID: 41393

ID 41393: Castor overall height 128 mm | 4 mounting holes with distance #\$\$ mm | Wheel with roller bearing and injection-moulded polyurethane tread with hardness 92 ° Shore A | No trail highway drive, low deformation if rarely moved, wide range of tempera

Product information

- Article code 2-054-20V
- SKU 41393
- EAN 3838461413933

Specifications

The result of our quality is maximum performance!

[Close](#)

[Close](#)

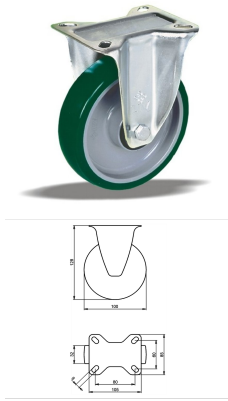

Product description

stainless steel Fixed castor with an overall height of 128 mm

Wheel diameter x width: 100 x 32 mm

Top plate with 4 mounting holes of 9 mm, mounting hole distance 80x60 mm and top plate outer dimensions: 105x85 mm

Wheel with plain bearing and injection-moulded polyurethane tread with hardness 92 ° Shore A on polyamide.

Approved and tested load capacity

Dynamic 150 kg

Static 180 kg

Temperature range:

Continuous operation: -25 | +55°C

Short (10 min) exposure: -30 | +55°C

Advantages of this No trail highway drive Fixed castor:

- ✓ deformation if rarely moved
- ✓ range of temperatures
- ✓ resistant

LIV SYSTEMS stainless steel Fixed castor + injection-moulded polyurethane tread Ø100 x W32mm for 150kg Prod

ID: 41354

ID 41354: Castor overall height 128 mm | 4 mounting holes with distance 80x60 mm | Wheel with plain bearing and injection-moulded polyurethane tread with hardness 92 ° Shore A | No trail highway drive, low deformation if rarely moved, wide range of temper

Product information

- Article code 2-051-20D
- SKU 41354
- EAN 3838461413544

Specifications

The result of our quality is maximum performance!

[Close](#)

[Close](#)

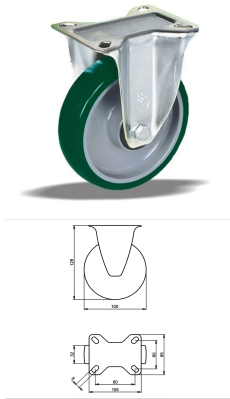

Product description

stainless steel Fixed castor with an overall height of 128 mm

Wheel diameter x width: 100 x 32 mm

Top plate with 4 mounting holes of 9 mm, mounting hole distance 80x60 mm and top plate outer dimensions: 105x85 mm

Wheel with roller bearing and injection-moulded polyurethane tread with hardness 92 ° Shore A on polyamide.

Approved and tested load capacity

Dynamic 150 kg

Static 180 kg

Temperature range:

Continuous operation: -25 | +55°C

Short (10 min) exposure: -30 | +55°C

Advantages of this No trail highway drive Fixed castor:

- ✓ deformation if rarely moved
- ✓ range of temperatures
- ✓ resistant

LIV SYSTEMS stainless steel Fixed castor + injection-moulded polyurethane tread Ø100 x W32mm for 150kg Prod

ID: 41353

ID 41353: Castor overall height 128 mm | 4 mounting holes with distance 80x60 mm | Wheel with roller bearing and injection-moulded polyurethane tread with hardness 92 ° Shore A | No trail highway drive, low deformation if rarely moved, wide range of tempe

Product information

- Article code 2-051-20V
- SKU 41353
- EAN 3838461413537

Specifications

The result of our quality is maximum performance!

[Close](#)

[Close](#)

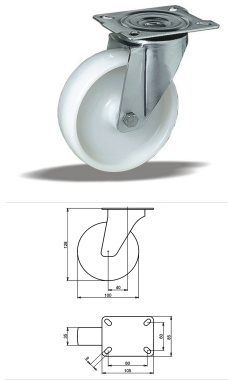

Product description

stainless steel Swivel castor with an overall height of 128 mm

Wheel diameter x width: 100 x 35 mm

Top plate with 4 mounting holes of 9 mm, mounting hole distance 80x60 mm and top plate outer dimensions: 105x85 mm

Wheel with plain bearing and solid polyamide wheel with hardness 70±5 Shore D.

Approved and tested load capacity

Dynamic 200 kg

Static 250 kg

Temperature range:

Continuous operation: -25 | +80°C

Short (10 min) exposure: -30 | +110°C

Advantages of this Steamy floor in Swivel castor:

- ✓ washing allowed
- ✓ shining
- ✓ hot and wet conditions

LIV SYSTEMS stainless steel Swivel castor + solid polyamide wheel Ø100 x W35mm for 200kg Prod ID: 41283

ID 41283: Castor overall height 128 mm | 4 mounting holes with distance 80x60 mm | Wheel with plain bearing and solid polyamide wheel with hardness 70±5 Shore D | Steamy floor in, frequent washing allowed, always shining, for hot and wet conditions

Product information

- Article code 2-671 A
- SKU 41283
- EAN 3838461412837

Specifications

The result of our quality is maximum performance!

[Close](#)

[Close](#)

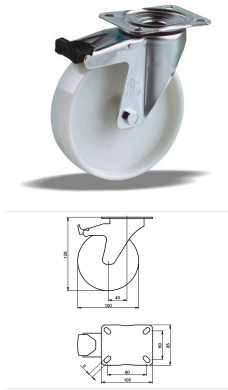

Product description

stainless steel Swivel castor with brake with an overall height of 128 mm
 Wheel diameter x width: 100 x 35 mm
 Top plate with 4 mounting holes of 9 mm, mounting hole distance 80x60 mm and top plate outer dimensions: 105x85 mm
 Wheel with plain bearing and solid polyamide wheel with hardness 70±5 Shore D
 the double brake system, brakes the turning of the wheel and the swivel rotation.

Approved and tested load capacity

Dynamic 200 kg
 Static 250 kg

Temperature range:

Continuous operation: -25 | +80°C
 Short (10 min) exposure: -30 | +110°C

Advantages of this Steamy floor in Swivel castor with brake:

- ✓ washing allowed
- ✓ shining
- ✓ hot and wet conditions

LIV SYSTEMS stainless steel Swivel castor with brake + solid polyamide wheel Ø100 x W35mm for 200kg Prod ID: 41303

ID 41303: Castor overall height 128 mm | 4 mounting holes with distance 80x60 mm | Wheel with plain bearing and solid polyamide wheel with hardness 70±5 Shore D | The double brake system, brakes the turning of the wheel and the swivel rotation. | Steamy

Product information

- Article code 2-683 A
- SKU 41303
- EAN 3838461413032

Specifications

The result of our quality is maximum performance!

[Close](#)

[Close](#)

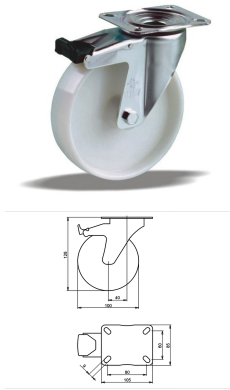

Product description

stainless steel Swivel castor with brake with an overall height of 128 mm

Wheel diameter x width: 100 x 35 mm

Top plate with 4 mounting holes of 9 mm, mounting hole distance 80x60 mm and top plate outer dimensions: 105x85 mm

Wheel with roller bearing and solid polyamide wheel with hardness 70±5 Shore D
the double brake system, brakes the turning of the wheel and the swivel rotation.

Approved and tested load capacity

Dynamic 200 kg

Static 250 kg

Temperature range:

Continuous operation: -25 | +80°C

Short (10 min) exposure: -30 | +110°C

Advantages of this Steamy floor in Swivel castor with brake:

- ✓ washing allowed
- ✓ shining
- ✓ hot and wet conditions

LIV SYSTEMS stainless steel Swivel castor with brake + solid polyamide wheel Ø100 x W35mm for 200kg Prod ID: 41295

ID 41295: Castor overall height 128 mm | 4 mounting holes with distance 80x60 mm | Wheel with roller bearing and solid polyamide wheel with hardness 70±5 Shore D | The double brake system, brakes the turning of the wheel and the swivel rotation. | Steamy

Product information

- Article code 2-722 A
- SKU 41295
- EAN 3838461412950

Specifications

The result of our quality is maximum performance!

[Close](#)

[Close](#)

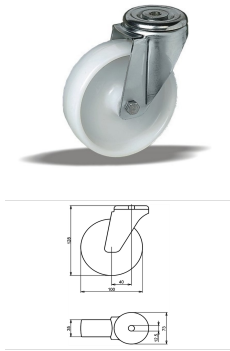

Product description

stainless steel Swivel castor with an overall height of 128 mm

Wheel diameter x width: 100 x 35 mm

Top plate with 4 mounting holes of 12,5 mm, mounting hole distance #\$\$ mm and top plate outer dimensions: 73 mm

Wheel with plain bearing and solid polyamide wheel with hardness 70±5 Shore D.

Approved and tested load capacity

Dynamic 200 kg

Static 250 kg

Temperature range:

Continuous operation: -25 | +80°C

Short (10 min) exposure: -30 | +110°C

Advantages of this Steamy floor in Swivel castor:

- ✓ washing allowed
- ✓ shining
- ✓ hot and wet conditions

LIV SYSTEMS stainless steel Swivel castor + solid polyamide wheel Ø100 x W35mm for 200kg Prod ID: 41323

ID 41323: Castor overall height 128 mm | 4 mounting holes with distance #\$\$ mm | Wheel with plain bearing and solid polyamide wheel with hardness 70±5 Shore D | Steamy floor in, frequent washing allowed, always shining, for hot and wet conditions

Product information

- Article code 2-766 L12
- SKU 41323
- EAN 3838461413230

Specifications

The result of our quality is maximum performance!

[Close](#)

[Close](#)

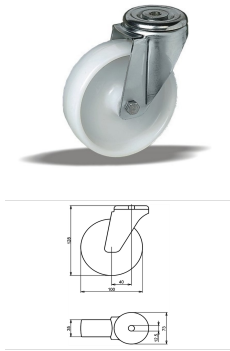

Product description

stainless steel Swivel castor with an overall height of 128 mm

Wheel diameter x width: 100 x 35 mm

Top plate with 4 mounting holes of 12,5 mm, mounting hole distance #\$\$ mm and top plate outer dimensions: 73 mm

Wheel with roller bearing and solid polyamide wheel with hardness 70±5 Shore D.

Approved and tested load capacity

Dynamic 200 kg

Static 250 kg

Temperature range:

Continuous operation: -25 | +80°C

Short (10 min) exposure: -30 | +110°C

Advantages of this Steamy floor in Swivel castor:

✓ washing allowed

✓ shining

✓ hot and wet conditions

LIV SYSTEMS stainless steel Swivel castor + solid polyamide wheel Ø100 x W35mm for 200kg Prod ID: 41315

ID 41315: Castor overall height 128 mm | 4 mounting holes with distance #\$\$ mm | Wheel with roller bearing and solid polyamide wheel with hardness 70±5 Shore D | Steamy floor in, frequent washing allowed, always shining, for hot and wet conditions

Product information

- Article code 2-756 L12
- SKU 41315
- EAN 3838461413155

Specifications

The result of our quality is maximum performance!

[Close](#)

[Close](#)

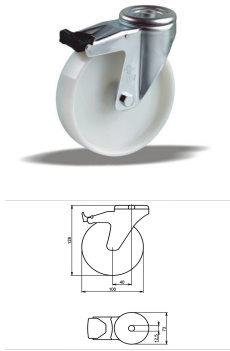

Product description

stainless steel Swivel castor with brake with an overall height of 128 mm
 Wheel diameter x width: 100 x 35 mm
 Top plate with 4 mounting holes of 12,5 mm, mounting hole distance #\$\$ mm and top plate outer dimensions: 73 mm
 Wheel with plain bearing and solid polyamide wheel with hardness 70±5 Shore D
 the double brake system, brakes the turning of the wheel and the swivel rotation.

Approved and tested load capacity

Dynamic 200 kg
 Static 250 kg

Temperature range:

Continious operation: -25 | +80°C
 Short (10 min) exposure: -30 | +110°C

Advantages of this Steamy floor in Swivel castor with brake:

- ✓ washing allowed
- ✓ shining
- ✓ hot and wet conditions

LIV SYSTEMS stainless steel Swivel castor with brake + solid polyamide wheel Ø100 x W35mm for 200kg Prod ID: 41343

ID 41343: Castor overall height 128 mm | 4 mounting holes with distance #\$\$ mm | Wheel with plain bearing and solid polyamide wheel with hardness 70±5 Shore D | The double brake system, brakes the turning of the wheel and the swivel rotation. | Steamy fl

Product information

- Article code 2-794 L12
- SKU 41343
- EAN 3838461413438

Specifications

The result of our quality is maximum performance!

[Close](#)

[Close](#)

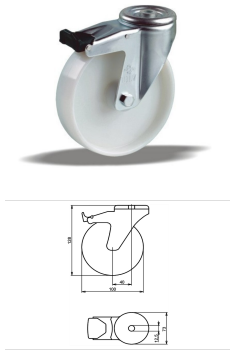

Product description

stainless steel Swivel castor with brake with an overall height of 128 mm

Wheel diameter x width: 100 x 35 mm

Top plate with 4 mounting holes of 12,5 mm, mounting hole distance #\$\$ mm and top plate outer dimensions: 73 mm

Wheel with roller bearing and solid polyamide wheel with hardness 70±5 Shore D

the double brake system, brakes the turning of the wheel and the swivel rotation.

Approved and tested load capacity

Dynamic 200 kg

Static 250 kg

Temperature range:

Continious operation: -25 | +80°C

Short (10 min) exposure: -30 | +110°C

Advantages of this Steamy floor in Swivel castor with brake:

- ✓ washing allowed
- ✓ shining
- ✓ hot and wet conditions

LIV SYSTEMS stainless steel Swivel castor with brake + solid polyamide wheel Ø100 x W35mm for 200kg Prod ID: 41335

ID 41335: Castor overall height 128 mm | 4 mounting holes with distance #\$\$ mm | Wheel with roller bearing and solid polyamide wheel with hardness 70±5 Shore D | The double brake system, brakes the turning of the wheel and the swivel rotation. | Steamy f

Product information

- Article code 2-789 L12
- SKU 41335
- EAN 3838461413353

Specifications

The result of our quality is maximum performance!

[Close](#)

[Close](#)

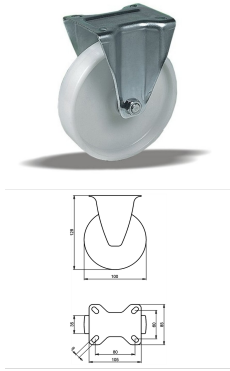

Product description

stainless steel Fixed castor with an overall height of 128 mm

Wheel diameter x width: 100 x 35 mm

Top plate with 4 mounting holes of 9 mm, mounting hole distance 80x60 mm and top plate outer dimensions: 105x85 mm

Wheel with plain bearing and solid polyamide wheel with hardness 70±5 Shore D.

Approved and tested load capacity

Dynamic 200 kg

Static 250 kg

Temperature range:

Continuous operation: -25 | +80°C

Short (10 min) exposure: -30 | +110°C

Advantages of this Steamy floor in Fixed castor:

- ✓ washing allowed
- ✓ shining
- ✓ hot and wet conditions

LIV SYSTEMS stainless steel Fixed castor + solid polyamide wheel Ø100 x W35mm for 200kg Prod ID: 41263

ID 41263: Castor overall height 128 mm | 4 mounting holes with distance 80x60 mm | Wheel with plain bearing and solid polyamide wheel with hardness 70±5 Shore D | Steamy floor in, frequent washing allowed, always shining, for hot and wet conditions

Product information

- Article code 2-676 A
- SKU 41263
- EAN 3838461412639

Specifications

The result of our quality is maximum performance!

[Close](#)

[Close](#)

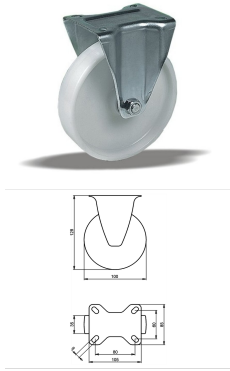

Product description

stainless steel Fixed castor with an overall height of 128 mm

Wheel diameter x width: 100 x 35 mm

Top plate with 4 mounting holes of 9 mm, mounting hole distance 80x60 mm and top plate outer dimensions: 105x85 mm

Wheel with roller bearing and solid polyamide wheel with hardness 70±5 Shore D.

Approved and tested load capacity

Dynamic 200 kg

Static 250 kg

Temperature range:

Continuous operation: -25 | +80°C

Short (10 min) exposure: -30 | +110°C

Advantages of this Steamy floor in Fixed castor:

- ✓ washing allowed
- ✓ shining
- ✓ hot and wet conditions

LIV SYSTEMS stainless steel Fixed castor + solid polyamide wheel Ø100 x W35mm for 200kg Prod ID: 41255

ID 41255: Castor overall height 128 mm | 4 mounting holes with distance 80x60 mm | Wheel with roller bearing and solid polyamide wheel with hardness 70±5 Shore D | Steamy floor in, frequent washing allowed, always shining, for hot and wet conditions

Product information

- Article code 2-666 A
- SKU 41255
- EAN 3838461412554

Specifications

The result of our quality is maximum performance!

[Close](#)

[Close](#)

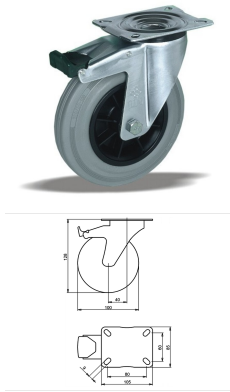

Product description

stainless steel Swivel castor with brake with an overall height of 128 mm

Wheel diameter x width: 100 x 32 mm

Top plate with 4 mounting holes of 9 mm, mounting hole distance 80x60 mm and top plate outer dimensions: 105x85 mm

Wheel with plain bearing and grey rubber tyre with hardness 83 ° shore A on polypropylene
the double brake system, brakes the turning of the wheel and the swivel rotation.

Approved and tested load capacity

Dynamic 80 kg

Static 100 kg

Temperature range:

Continuous operation: -20 | +70°C

Short (10 min) exposure: -30 | +80°C

Advantages of this Floor floor turns Swivel castor with brake:

- ✓ preservation
- ✓ and steam proof
- ✓ obstacle smooth pass

LIV SYSTEMS stainless steel Swivel castor with brake + grey rubber tyre Ø100 x W32mm for 80kg Prod ID: 41515

ID 41515: Castor overall height 128 mm | 4 mounting holes with distance 80x60 mm | Wheel with plain bearing and grey rubber tyre with hardness 83 ° shore A | The double brake system, brakes the turning of the wheel and the swivel rotation. | Floor floor

Product information

- Article code 2-936 ISO
- SKU 41515
- EAN 3838461415159

Specifications

The result of our quality is maximum performance!

[Close](#)

[Close](#)

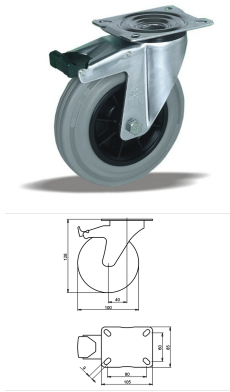

Product description

stainless steel Swivel castor with brake with an overall height of 128 mm
 Wheel diameter x width: 100 x 32 mm
 Top plate with 4 mounting holes of 9 mm, mounting hole distance 80x60 mm and top plate outer dimensions: 105x85 mm
 Wheel with roller bearing and grey rubber tyre with hardness 83 ° shore A on polypropylene
 the double brake system, brakes the turning of the wheel and the swivel rotation.

Approved and tested load capacity

Dynamic 80 kg
 Static 100 kg

Temperature range:

Continuous operation: -20 | +70°C
 Short (10 min) exposure: -30 | +80°C

Advantages of this Floor floor turns Swivel castor with brake:

- ✓ preservation
- ✓ and steam proof
- ✓ obstacle smooth pass

LIV SYSTEMS stainless steel Swivel castor with brake + grey rubber tyre Ø100 x W32mm for 80kg Prod ID: 41514

ID 41514: Castor overall height 128 mm | 4 mounting holes with distance 80x60 mm | Wheel with roller bearing and grey rubber tyre with hardness 83 ° shore A | The double brake system, brakes the turning of the wheel and the swivel rotation. | Floor floor

Product information

- Article code 2-929 ISO
- SKU 41514
- EAN 3838461415142

Specifications

The result of our quality is maximum performance!

[Close](#)

[Close](#)

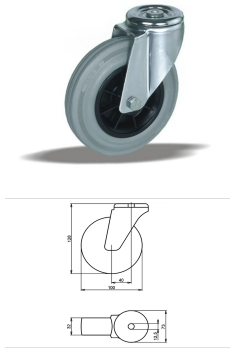

Product description

stainless steel Swivel castor with an overall height of 128 mm

Wheel diameter x width: 100 x 32 mm

Top plate with 4 mounting holes of 12,5 mm, mounting hole distance 73 mm and top plate outer dimensions: 73 mm

Wheel with plain bearing and grey rubber tyre with hardness 83 ° shore A on polypropylene.

Approved and tested load capacity

Dynamic 80 kg

Static 100 kg

Temperature range:

Continuous operation: -20 | +70°C

Short (10 min) exposure: -30 | +80°C

Advantages of this Floor floor turns Swivel castor:

- ✓ preservation
- ✓ and steam proof
- ✓ obstacle smooth pass

LIV SYSTEMS stainless steel Swivel castor + grey rubber tyre Ø100 x W32mm for 80kg Prod ID: 41535

ID 41535: Castor overall height 128 mm | 4 mounting holes with distance 73 mm | Wheel with plain bearing and grey rubber tyre with hardness 83 ° shore A | Floor floor turns, floor preservation, wet and steam proof, low obstacle smooth pass

Product information

- Article code 2-973 L12
- SKU 41535
- EAN 3838461415357

Specifications

The result of our quality is maximum performance!

[Close](#)

[Close](#)

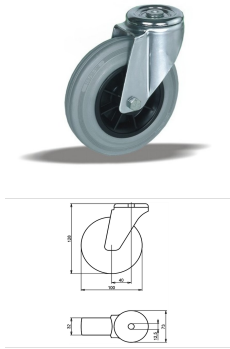

Product description

stainless steel Swivel castor with an overall height of 128 mm

Wheel diameter x width: 100 x 32 mm

Top plate with 4 mounting holes of 12,5 mm, mounting hole distance #\$\$ mm and top plate outer dimensions: 73 mm

Wheel with roller bearing and grey rubber tyre with hardness 83 ° shore A on polypropylene.

Approved and tested load capacity

Dynamic 80 kg

Static 100 kg

Temperature range:

Continous operation: -20 | +70°C

Short (10 min) exposure: -30 | +80°C

Advantages of this Floor floor turns Swivel castor:

- ✓ preservation
- ✓ and steam proof
- ✓ obstacle smooth pass

LIV SYSTEMS stainless steel Swivel castor + grey rubber tyre Ø100 x W32mm for 80kg Prod ID: 41534

ID 41534: Castor overall height 128 mm | 4 mounting holes with distance #\$\$ mm | Wheel with roller bearing and grey rubber tyre with hardness 83 ° shore A | Floor floor turns, floor preservation, wet and steam proof, low obstacle smooth pass

Product information

- Article code 2-966 L12
- SKU 41534
- EAN 3838461415340

Specifications

The result of our quality is maximum performance!

[Close](#)

[Close](#)

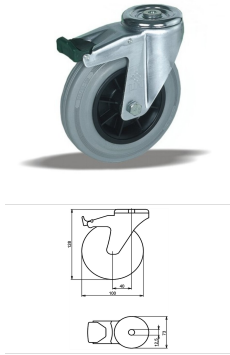

Product description

stainless steel Swivel castor with brake with an overall height of 128 mm
 Wheel diameter x width: 100 x 32 mm
 Top plate with 4 mounting holes of 12,5 mm, mounting hole distance #\$\$ mm and top plate outer dimensions: 73 mm
 Wheel with plain bearing and grey rubber tyre with hardness 83 ° shore A on polypropylene
 the double brake system, brakes the turning of the wheel and the swivel rotation.

Approved and tested load capacity

Dynamic 80 kg
 Static 100 kg

Temperature range:

Continious operation: -20 | +70°C
 Short (10 min) exposure: -30 | +80°C

Advantages of this Floor floor turns Swivel castor with brake:

- ✓ preservation
- ✓ and steam proof
- ✓ obstacle smooth pass

LIV SYSTEMS stainless steel Swivel castor with brake + grey rubber tyre Ø100 x W32mm for 80kg Prod ID: 41555

ID 41555: Castor overall height 128 mm | 4 mounting holes with distance #\$\$ mm | Wheel with plain bearing and grey rubber tyre with hardness 83 ° shore A | The double brake system, brakes the turning of the wheel and the swivel rotation. | Floor floor tu

Product information

- Article code 2-987 L12
- SKU 41555
- EAN 3838461415555

Specifications

The result of our quality is maximum performance!

[Close](#)

[Close](#)

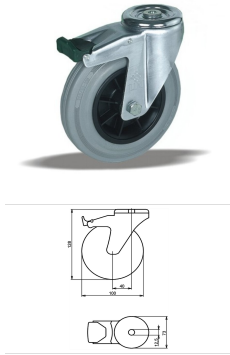

Product description

stainless steel Swivel castor with brake with an overall height of 128 mm
 Wheel diameter x width: 100 x 32 mm
 Top plate with 4 mounting holes of 12,5 mm, mounting hole distance #\$\$ mm and top plate outer dimensions: 73 mm
 Wheel with roller bearing and grey rubber tyre with hardness 83 ° shore A on polypropylene
 the double brake system, brakes the turning of the wheel and the swivel rotation.

Approved and tested load capacity

Dynamic 80 kg
 Static 100 kg

Temperature range:

Continious operation: -20 | +70°C
 Short (10 min) exposure: -30 | +80°C

Advantages of this Floor floor turns Swivel castor with brake:

- ✓ preservation
- ✓ and steam proof
- ✓ obstacle smooth pass

LIV SYSTEMS stainless steel Swivel castor with brake + grey rubber tyre Ø100 x W32mm for 80kg Prod ID: 41554

ID 41554: Castor overall height 128 mm | 4 mounting holes with distance #\$\$ mm | Wheel with roller bearing and grey rubber tyre with hardness 83 ° shore A | The double brake system, brakes the turning of the wheel and the swivel rotation. | Floor floor t

Product information

- Article code 2-980 L12
- SKU 41554
- EAN 3838461415548

Specifications

The result of our quality is maximum performance!

[Close](#)

[Close](#)

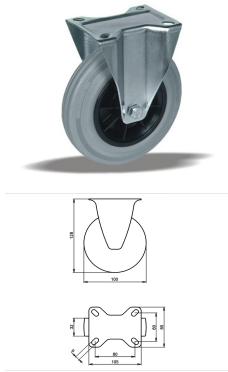

Product description

stainless steel Fixed castor with an overall height of 128 mm

Wheel diameter x width: 100 x 32 mm

Top plate with 4 mounting holes of 9 mm, mounting hole distance 80x60 mm and top plate outer dimensions: 105x85 mm

Wheel with plain bearing and grey rubber tyre with hardness 83 ° shore A on polypropylene.

Approved and tested load capacity

Dynamic 80 kg

Static 100 kg

Temperature range:

Continuous operation: -20 | +70°C

Short (10 min) exposure: -30 | +80°C

Advantages of this Floor floor turns Fixed castor:

- ✓ preservation
- ✓ and steam proof
- ✓ obstacle smooth pass

LIV SYSTEMS stainless steel Fixed castor + grey rubber tyre Ø100 x W32mm for 80kg Prod ID: 41475

ID 41475: Castor overall height 128 mm | 4 mounting holes with distance 80x60 mm | Wheel with plain bearing and grey rubber tyre with hardness 83 ° shore A | Floor floor turns, floor preservation, wet and steam proof, low obstacle smooth pass

Product information

- Article code 2-959 ISO
- SKU 41475
- EAN 3838461414756

Specifications

The result of our quality is maximum performance!

[Close](#)

[Close](#)

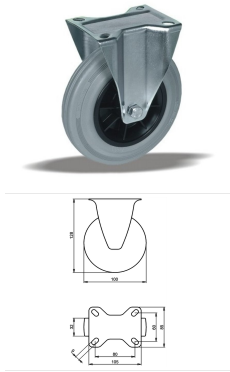

Product description

stainless steel Fixed castor with an overall height of 128 mm

Wheel diameter x width: 100 x 32 mm

Top plate with 4 mounting holes of 9 mm, mounting hole distance 80x60 mm and top plate outer dimensions: 105x85 mm

Wheel with roller bearing and grey rubber tyre with hardness 83 ° shore A on polypropylene.

Approved and tested load capacity

Dynamic 80 kg

Static 100 kg

Temperature range:

Continuous operation: -20 | +70°C

Short (10 min) exposure: -30 | +80°C

Advantages of this Floor floor turns Fixed castor:

- ✓ preservation
- ✓ and steam proof
- ✓ obstacle smooth pass

LIV SYSTEMS stainless steel Fixed castor + grey rubber tyre Ø100 x W32mm for 80kg Prod ID: 41474

ID 41474: Castor overall height 128 mm | 4 mounting holes with distance 80x60 mm | Wheel with roller bearing and grey rubber tyre with hardness 83 ° shore A | Floor floor turns, floor preservation, wet and steam proof, low obstacle smooth pass

Product information

- Article code 2-952 ISO
- SKU 41474
- EAN 3838461414749

Алматы (7273)495-231
Ангарск (3955)60-70-56
Архангельск (8182)63-90-72
Астрахань (8512)99-46-04
Барнаул (3852)73-04-60
Белгород (4722)40-23-64
Благовещенск (4162)22-76-07
Брянск (4832)59-03-52
Владивосток (423)249-28-31
Владикавказ (8672)28-90-48
Владимир (4922)49-43-18
Волгоград (844)278-03-48
Вологда (8172)26-41-59
Воронеж (473)204-51-73
Екатеринбург (343)384-55-89

Иваново (4932)77-34-06
Ижевск (3412)26-03-58
Иркутск (395)279-98-46
Казань (843)206-01-48
Калининград (4012)72-03-81
Калуга (4842)92-23-67
Кемерово (3842)65-04-62
Киров (8332)68-02-04
Коломна (4966)23-41-49
Кострома (4942)77-07-48
Краснодар (861)203-40-90
Красноярск (391)204-63-61
Курск (4712)77-13-04
Курган (3522)50-90-47
Липецк (4742)52-20-81

Магнитогорск (3519)55-03-13
Москва (495)268-04-70
Мурманск (8152)59-64-93
Набережные Челны (8552)20-53-41
Нижний Новгород (831)429-08-12
Новокузнецк (3843)20-46-81
Новосибирск (383)227-86-73
Омск (3812)21-46-40
Орел (4862)44-53-42
Оренбург (3532)37-68-04
Пенза (8412)22-31-16
Петрозаводск (8142)55-98-37
Псков (8112)59-10-37
Пермь (342)205-81-47

Ростов-на-Дону (863)308-18-15
Рязань (4912)46-61-64
Самара (846)206-03-16
Санкт-Петербург (812)309-46-40
Саратов (845)249-38-78
Севастополь (8692)22-31-93
Саранск (8342)22-96-24
Симферополь (3652)67-13-56
Смоленск (4812)29-41-54
Сочи (862)225-72-31
Ставрополь (8652)20-65-13
Сургут (3462)77-98-35
Сыктывкар (8212)25-95-17
Тамбов (4752)50-40-97
Тверь (4822)63-31-35

Тольятти (8482)63-91-07
Томск (3822)98-41-53
Тула (4872)33-79-87
Тюмень (3452)66-21-18
Ульяновск (8422)24-23-59
Улан-Удэ (3012)59-97-51
Уфа (347)229-48-12
Хабаровск (4212)92-98-04
Чебоксары (8352)28-53-07
Челябинск (351)202-03-61
Череповец (8202)49-02-64
Чита (3022)38-34-83
Якутск (4112)23-90-97
Ярославль (4852)69-52-93

Россия +7(495)268-04-70

Казахстан +7(7172)727-132

Киргизия +996(312)96-26-47

<https://liv.nt-rt.ru/> || vis@nt-rt.ru